

Reliefs middle paint

厦光浮雕中层漆



产品特性：
厦光浮雕中层漆是以丙烯酸乳液加入填料及助剂配制而成，能创造出具有凹凸形状立体浮雕点状纹理的一种中层料。

Product features:
SUNSHINE embossed Middle coating is formed adding fillers and additives based on acrylic emulsion preparation, can create a concave shape stereo Anaglyph-like texture, a kind of intermediate materials.

- 性能特点：**
- | | | |
|----------|----------|---------|
| ■ 高固体含量 | ■ 干燥收缩小 | ■ 点型饱满 |
| ■ 耐水性好 | ■ 粘结强度高 | ■ 耐久性好 |
| ■ 立体装饰效果 | ■ 弥盖细微裂缝 | ■ 优良施工性 |
- Application of places**
- | | | |
|----------------------------------|--------------------------|-------------------------|
| • High solids content | • Drying shrinkage | • Point-full |
| • Good water resistance | • High bonding strength | • Good durability |
| • Dimensional decorative effects | • Masked for tiny cracks | • Excellent workability |

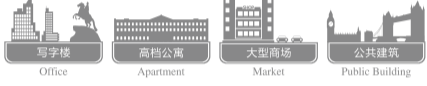

适用场所：
配套各种面漆，营造出多种立体花纹，起到立体装饰效果。

Application of places
Supporting a variety of finishes, creating a variety of three-dimensional pattern, played solid decorative effect.

技术参数：

基 料：丙烯酸乳液。
延 伸 率：> 150%。
产 品 特 征：水溶性、厚质、白色。
干 燥 时 间：表干6小时，重涂24小时，实干48小时（温度25℃，相对湿度80%）。
理论耗漆量：粗纹: 1.50kg/m²，中纹: 1.00kg/m²，细纹: 0.80kg/m²。实际涂布量因基面状况、施工方法不同有所差异。

Technical parameters

Base material: acrylic emulsion
Elongation: ≥ 150%
Product features: water-soluble, thick, white
Drying time: dry for 6 hours, Recoat time 24 hours, work for 48 hours. (Temperature 25℃, relative humidity 80%)
consumption of paint: rough 1.50kg/m², lines 1.00kg/m², lines 0.80kg/m², the actual coating by surface conditions, construction methods varied.

施 工：

施工方法：专用喷枪喷涂。如做平点，需作压平处理。
稀释比例：无须加水，确因施工困难，可酌加3%以内清水稀释。
施工要求：在5℃-35℃及相对湿度80%以下施工。大风、下雨等恶劣天气应避免施工。

Technical parameters

Construction method: Special spray. Flat spot, need to be flattened.
Dilution ratio: In addition to water, due to construction difficulties, may be subject to additional 3% less than clear water dilution.
Construction requirements: 5℃ -35℃ and relative humidity below 80% construction. Construction of wind, rain and other inclement weather should be avoided.

注意事项：

由于是厚质涂层，涂层实际干燥时间较长，夏、秋季2天以上；春、冬季3天以上，方可涂刷水性面漆。如要在中层料上涂刷油性等致密面漆时，必须确保中层料是安全干燥的（含水率≤10%）。为此，建议夏、秋干燥4天为宜；春、秋季干燥6天为宜，否则可能因中层料所含水份的蒸发产生向外推力，引起面漆起鼓现象。

Notes:

Because it is a thick coating, coating the actual drying time is longer in summer and autumn for more than 2 days; for more than 3 days in spring and winter, water before brushing a topcoat. To brushing oil on the Middle material such as tight when you finish, you must ensure that the intermediate material is safe and dry (moisture content ≤ 10%). For this reason, it is recommended that summer and autumn dry for 4 days; drying for 6 days in spring and autumn is appropriate, otherwise it may be Middle material resulting from the evaporation of the water contained thrust outward, causing paint played drums.



配套产品：
Accessory products

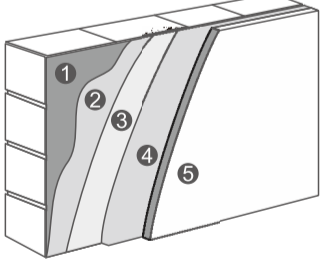

- 1 厦光水性氟碳漆
 - 2 厦光硅丙外墙晴雨漆
 - 3 厦光全天候外墙漆
 - 4 厦光丙烯酸外墙漆
 - 5 厦光弹性涂料
- ① Waterborne fluorocarbon coatings
② Silicon acrylic exterior paint rain
③ All weather exterior wall paint
④ Acrylic exterior pain
⑤ Elastic coatings

Orange peel-like middle paint

厦光砂壁状中层漆



产品特性：
厦光砂壁状中层漆由纯丙烯酸乳液及天然石英砂骨料等材料组成，具有优异的柔韧性能，有效弥盖墙体裂缝，附着力强、纹理多样、色彩丰富，是一种砂石质感纹理中层料。

Product features:
SUNSHINE middle-level material is made of pure acrylic emulsion sand texture and natural materials, such as silica sand aggregate composition, with excellent performance and flexibility, effectively masked wall cracks, strong adhesion, variety of textures, colors, is a sand texture textured Middle material.

- 性能特点：**
- | | | |
|----------|-------------|--------|
| ■ 砂石粗犷纹理 | ■ 弥盖墙体裂缝 | ■ 附着力强 |
| ■ 耐水性好 | ■ 致密性好，不吸料 | ■ 纹理多样 |
| ■ 防水性好 | ■ 毛面石和火烧石效果 | ■ 施工简单 |
- Application of places**
- | | | |
|----------------------------|----------------------------------|-----------------------|
| • Gravel and rough texture | • Masked wall cracks | • Strong adhesion |
| • Good water resistance | • Good compactness, no suction | • Texture variety |
| • Good waterproofing | • Surface stones and fire stones | • Simple construction |



适用场所：

一种砂石纹理效果中层料，配套各种岩彩石涂料，营造出毛面石和火烧石纹理效果。

Application of places

A sand texture effect Middle material, supporting a variety of colored rock stone coatings, create a rough surface stones and fire stones texture effect.

技术参数：

基 料：丙烯酸乳液。
延 伸 率：>150%。
产 品 特 征：水溶性、厚质、彩色。
干 燥 时 间：表干6小时，重涂24小时，实干48小时（温度25℃，相对湿度80%）。
理论耗漆量：2.00~3.50kg/m²，实际涂布量因基面状况、施工方法不同有所差异。

Technical parameters

Base material: acrylic emulsion
Elongation: ≥ 150%
Product features: water-soluble, thick, color
Drying time: dry for 6 hours, Recoat time 24 hours, work for 48 hours. (Temperature 25℃, relative humidity 80%)
consumption of paint: 2.00~3.50kg/m², the actual coating by surface conditions, construction methods varied.

施 工：

施工方法：专用喷枪喷涂。
稀释比例：无须加水，确因施工困难，可酌加5%以内清水稀释。
施工要求：在5℃-35℃及相对湿度80%以下施工。大风、下雨等恶劣天气应避免施工。

Technical parameters

Construction method: Proprietary spray
Dilution ratio: In addition to water, due to construction difficulties, may be subject to additional 5% less than clear water dilution.
Construction requirements: 5℃ ~35℃ and relative humidity below 80% construction. Construction of wind, rain and other inclement weather should be avoided.

注意事项：

由于是厚质涂层，涂层实际干燥时间较长，夏、秋季2天以上；春、冬季3天以上，方可涂刷水性面漆。如要在中层料上涂刷油性等致密面漆时，必须确保中层料是安全干燥的（含水率≤10%）。为此，建议夏、秋干燥4天为宜；春、秋季干燥6天为宜，否则可能因中层料所含水份的蒸发产生向外推力，引起面漆起鼓现象。

Notes:

Because it is a thick coating, coating the actual drying time is longer in summer and autumn for more than 2 days; for more than 3 days in spring and winter, water before brushing a topcoat. To brushing oil on the Middle material such as tight when you finish, you must ensure that the intermediate material is safe and dry (moisture content ≤10%). For this reason, it is recommended that summer and autumn dry for 4 days; drying for 6 days in spring and autumn is appropriate, otherwise it may be Middle material resulting from the evaporation of the water contained thrust outward, causing paint played drums.



配套产品：

Accessory products

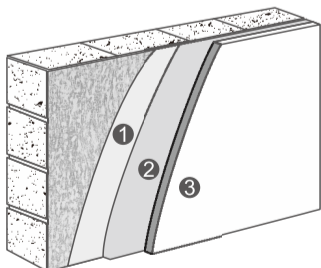

- ① 厦光薄质弹性涂料
② 厦光耐碱型水性涂料
③ 厦光BME型岩彩石涂料
- ① Thin elastic coatings
② Weather-resistant waterborne coatings
③ BME-rock stone coating

Elasticity middle paint

厦光弹性中层漆



产品特性：
厦光弹性中层漆是具有一定弹性延伸率的中层涂料，它不仅性能优异，而且能够弥盖墙体裂缝，能与多种面层涂料复层组合成厚膜型弹性涂膜，能创造出立体桔皮纹状的耐久型复层弹性中层漆。

Product features:
SUNSHINE elastic intermediate coat paint is a 250% Middle elastic elongation of paint, it not only excellent performance, but can be masked for wall cracks, can be combined with a variety of surface coating layer for compound into thick film coated with elastic, can create solid orange peel laminated durable elastic Middle compound layer of paint.

- 性能特点：**
- | | | |
|----------|----------|--------|
| ■ 具有弹性 | ■ 弥盖墙体裂缝 | ■ 附载性好 |
| ■ 高固含量 | ■ 干燥不收缩 | ■ 耐水性好 |
| ■ 不同纹理效果 | ■ 点型饱满圆滑 | ■ 施工性好 |
- Application of places**
- | | | |
|---------------------------------|----------------------|-------------------------|
| • With elastic | • Masked wall cracks | • Incorporate good |
| • High solid content | • Drying shrinkage | • Good water resistance |
| • Effects of different textures | • Full round | • Well construction |



适用场所：
配套各种弹性面漆，组合成为弹性涂膜，创造多层次的艺术纹理，起到弥盖裂缝的效果。

Application of places
Supporting a variety of elastic topcoat, combine them into elastic coating, creating multi-level art textures, played masked crack effect.

技术参数：

基 料：丙烯酸弹性乳液。
延 伸 率：弹性：≥250%；柔性：≥150%。
产 品 特 征：水溶性、厚质、白色。
干 燥 时 间：表干6小时，重涂24小时，实干48小时（温度25℃，相对湿度80%）。
理论耗漆量：粗纹: 1.00kg/m²，中纹: 0.80kg/m²，细纹: 0.60kg/m²。
（实际涂布量因基面状况、施工方法不同而略有差异）。

Technical parameters

Base material: acrylic emulsion
Elongation: ≥ 250%
Product features: water-soluble, thick, white, Matt
Drying time: dry for 6 hours, Recoat time 24 hours, work for 48 hours. (Temperature 25℃, relative humidity 80%)
consumption of paint: Rough: 1.00kg/m², line: 0.80kg/m², fine lines: 0.60kg/m², the actual coating by surface conditions, construction methods varied.

施 工：

施工方法：采用专用辊筒施工，根据纹理大小分别选用粗目或细目辊筒。
稀释比例：无须加水，确因施工困难，可酌加3%以内清水稀释。
施工要求：在5℃-35℃及相对湿度80%以下施工。大风、下雨等恶劣天气应避免施工。

Technical parameters

Construction method: Using special rollers for construction, according to texture size separately a breakdown of coarse or roller.
Dilution ratio: In addition to water, due to construction difficulties, may be subject to additional 3% less than clear water dilution.
Construction requirements: 5℃ ~35℃ and relative humidity below 80% construction. Construction of wind, rain and other inclement weather should be avoided.

基层的开裂
The cracking of the grass-roots level

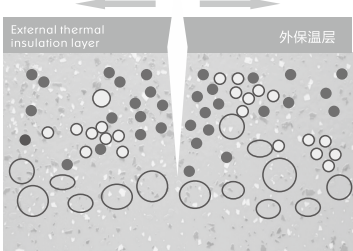

底材干燥过程中由于收缩、应力变化、温度变化容易产生裂缝
Substrate drying process due to shrinkage, stress, temperature changes easy to crack

弹性涂层的抗开裂
Cracking resistance of elastomeric coating

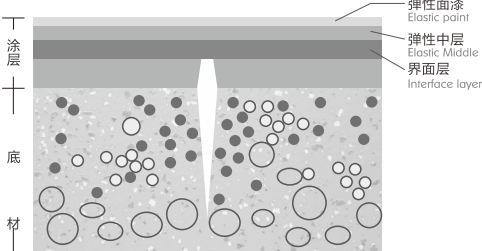

强韧的弹性涂膜可以遮盖裂缝
Resilient-elastic coating to cover cracks

配套产品：
Accessory products

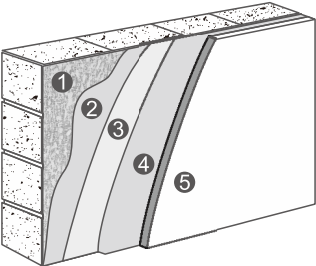

- 1 厦光水性氟碳漆
- 2 厦光丙烯酸硅高弹性涂料
- 3 厦光多机能弹性涂料
- 4 厦光三合一弹性涂料
- 5 厦光BME型彩石涂料

- 1 Waterborne fluorocarbon coatings
- 2 Acrylic Silicon high-elastic coatings
- 3 Multi-functional elastic coatings
- 4 Three-in-one elastic coatings
- 5 BME-rock stone coating