

# water-based acrylic silicon steel finishes

## 厦光水性丙烯酸硅罩面漆



### 产品特性：

厦光水性丙烯酸硅罩面漆是经硅改性的特种憎水性罩面漆，渗透力强、附着力高，涂膜具有一定的防水性、耐化学品性、抗黄变、耐水白、高耐久、抗沾污等优异功能。

### Product features:

SUNSHINE Silicon-acrylic finish is the modification of special water-repellent finish, strong penetrability, high adhesion, coating has a certain degree of water resistance, chemical resistance and yellowing resistance, water resistance, high durability, stain resistance and excellent features.

### 性能特点：

- 优异的耐候性
- 出色的抗沾污性
- 防水性好
- 憎水性
- 优异耐黄变
- 抗紫外线
- 优异耐化学品性
- 抗老化性极佳
- 防霉抗菌

### Application of places

- Excellent weatherability
- Excellent resistance to stains
- Good waterproofing
- Water repellency
- Excellent resistance to yellowing
- UV-resistant
- Excellent chemical resistance
- Anti-aging and excellent
- Low surface tension

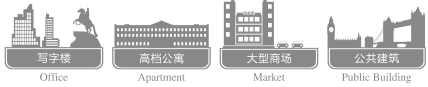

### 适用场所：

适用于真石漆、花岗岩、岩彩石涂料、陶彩砖涂料、质感涂料等罩面，也可用于其它水溶性涂料的罩面，起到保护表面涂层功能。

### Application of places

Applied to real stone paint, rocks, Tao Cai brick paint overlay color stone coating, can also be used to cover other water-soluble paint, surface coating to protect function.

### 技术参数：

基 料：硅树脂改性丙烯酸乳液。  
产 品 特 征：水溶性、薄质、透明、有光/亚光。  
干 燥 时 间：表干2小时，重涂6小时，实干24小时（温度25℃，相对湿度80%）。  
理论耗漆量：0.12~0.15kg/m<sup>2</sup>，实际涂布量因基面状况、施工方法不同有所差异。

### Technical parameters

Base material: Silicone modified acrylic emulsion  
Product features: Water solubility, thin, transparent, light/Matt  
Drying time: dry for 2 hours, Recoat time 6 hours, work for 24 hours. (Temperature 25℃, relative humidity 80%)  
consumption of paint: 0.12~0.15kg/m<sup>2</sup>, the actual coating by surface conditions, construction methods varied.

### 施 工：

施工方法：刷涂、滚涂、喷涂。  
稀释比例：不建议稀释。  
施工要求：在5℃-35℃及相对湿度80%以下施工。大风、下雨等恶劣天气应避免施工。

### Technical parameters

Construction method: Brush, roller coating, spray  
Dilution ratio: Not recommended for dilution  
Construction requirements: 5℃ ~35℃ and relative humidity below 80% construction. Construction of wind, rain and other inclement weather should be avoided.

### 纯有机硅树脂、自洁型光触媒罩面漆

Pure silicone, self-cleaning Photocatalyst finish



普通罩面效果 General overlay effect



普通罩面效果 General overlay effect



有机硅罩面效果 Silicone overlay effect

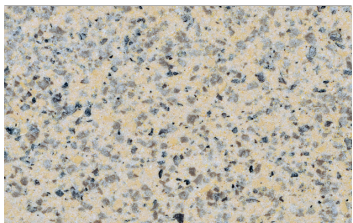

自洁型罩面效果 Self-cleaning-overlay effect

### 配套产品：

Accessory products

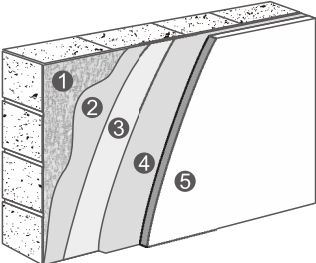

- ❶ 厦光天然真石漆
- ❷ 厦光花岗岩涂料
- ❸ 厦光岩彩石涂料
- ❹ 厦光质感涂料
- ❺ 厦光仿砖涂料
- ❶ Natural really stone paint
- ❷ Granite paint
- ❸ Rock stone coating
- ❹ Texture paint
- ❺ Faux brick paint



# Self-cleaning type steel finishes

## 厦光自洁型罩面漆



### 产品特性：

由经硅改性无机高分子合成树脂和特种添加剂组成的水性罩面涂料，该产品有很强的光触媒效应，涂膜吸收阳光的紫外线后，使表面达到超亲水性，可分解涂膜表面污物，具有自清洁功能。

### Product features:

By inorganic polymer resins and specialty silicone modified waterborne overlay coatings addiives, this product has a strong effect of Photocatalyst coating after absorbing the ultraviolet rays of the Sun, the surface reaches Super-hydrophilicity, biodegradable coating surface dirt, and self-cleaning function.

### 性能特点：

- 自清洁功能
- 耐老化性极强
- 防水性好
- 憎水性
- 优异耐黄变
- 超强附着力
- 极强的抗沾污性
- 防霉抗藻
- 优异耐候性

### Application of places

- Self-cleaning function
- Strong resistance to ageing
- Good waterproofing
- Water repellency
- Excellent resistance to yellowing
- Ultra strong adhesion
- Strong resistance to stains
- Mildew resistant algae
- Excellent weatherability

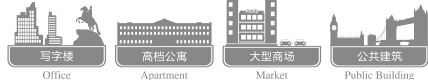

### 适用场所：

特别适用于真石漆、花岗岩涂料、斑彩石涂料等对耐污性要求较高的涂层罩面。

### Application of places

Especially for real stone paint, granite coating, Ammolite high requirements for stain-resistant coating such as paint overlay

### 技术参数：

- 基 料：硅改性无机高分子树脂和特种光触媒剂。
- 产 品 特 征：水溶性、薄质、透明、亚光。
- 干 燥 时 间：表干2小时，重涂6小时，实干24小时（温度25℃，相对湿度80%）。
- 理论耗漆量：0.12~0.15kg/m<sup>2</sup>，实际涂布量因基面状况、施工方法不同有所差异。

### Technical parameters

Base material: Silicon modified inorganic polymer resins and specialty photo-catalyst agent.  
Product features: Water solubility, thin, transparent, Matt.  
Drying time: dry for 2 hours, Recoat time 6 hours, work for 24 hours. (Temperature 25℃, relative humidity 80%)  
consumption of paint: 0.12-0.15kg/m<sup>2</sup>, the actual coating by surface conditions, construction methods varied.

### 施 工：

- 施工方法：刷涂、滚涂、喷涂。
- 稀释比例：不建议稀释。
- 施工要求：在5℃-35℃及相对湿度80%以下施工。大风、下雨等恶劣天气应避免施工。

### Technical parameters

Construction method: Brush, roller coating, spray  
Dilution ratio: Not recommended for dilution  
Construction requirements: 5℃ ~35℃ and relative humidity below 80% construction. Construction of wind, rain and other inclement weather should be avoided.

### 配套产品：

Accessory products

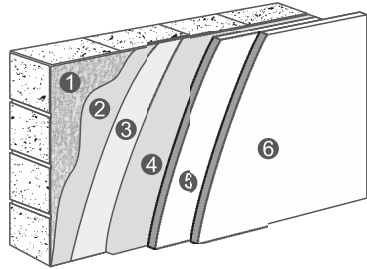

- ① 厦光天然真石漆
- ② 厦光花岗岩涂料
- ③ 厦光斑彩石涂料
- ④ 厦光斑彩石涂料
- ⑤ 厦光质感涂料
- ⑥ 厦光仿砖涂料
- ① Natural really stone paint
- ② Granite paint
- ③ Rock stone coatings
- ④ Ammolite coatings
- ⑤ Texture paint
- ⑥ Faux brick paint

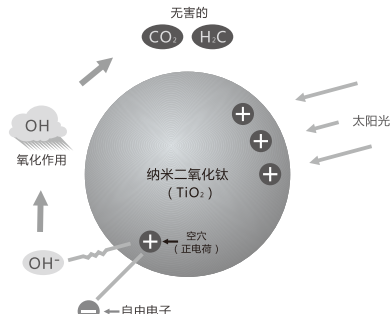

抗污原理：紫外线照射后涂膜会产生·OH，·OH是光催化中主要氧化剂。用纳米TiO<sub>2</sub>作光催化剂引发氧化还原反应，可降解几乎所有的有机污物。

Stain Principle: After UV irradiation coating will produce·OH, ·OH is the main oxidant photocatalysis. Nano TiO<sub>2</sub> as photocatalyst triggered redox reaction, almost all of the biodegradable organic dirt.



# high stain-resistant polyurethane cover finish

## 厦光水性氟碳罩面漆



### 产品特性：

以水性氟碳树脂为基料，添加各种助剂研制而成，该产品具有优异的耐久性、抗沾污性、耐化学品性，杰出的户外保色性，能经受风吹、日晒、雨淋等严酷自然环境全面考验，是一种性价比比较高的专家型罩面漆。

### Product features:

Using waterborne fluorocarbon resin as the binder, added various additives designed and developed, the product has excellent durability, stain resistance, chemical resistance, excellent outdoor color retention, and able to withstand wind, Sun, rain and harsh natural environment, such as the comprehensive test, is a cost-effective expert finish.

### 性能特点：

- |            |            |           |
|------------|------------|-----------|
| ■ 超长耐候性    | ■ 优异抗沾污性   | ■ 优异耐化学品性 |
| ■ 杰出抗紫外线能力 | ■ 抵抗户外严酷环境 | ■ 优异耐黄变   |
| ■ 防霉抗藻     | ■ 防水性好     | ■ 水性环保型   |

### Application of places

- |                             |                                   |                                     |
|-----------------------------|-----------------------------------|-------------------------------------|
| • Ultra long durability     | • Excellent resistance to stains  | • Excellent chemical resistance     |
| • Outstanding UV resistance | • Resistance to harsh environment | • Excellent resistance to yellowing |
| • Mildew resistant algae    | • Good waterproofing              | • Water environmental protection    |

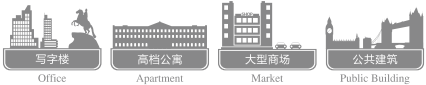

### 适用场所：

适用于真石漆、花岗岩涂料、岩彩石涂料、陶瓷石涂料、斑彩石涂料、质感涂料、仿砖涂料等，特别适用于严酷环境地区墙面使用。

### Application of places

Applied to real stone paint, paint, colored rock of granite stone coatings, ceramics, Ammolite stone coating paint, textured paints, faux brick painting, especially suitable for walls used in harsh environment areas.

### 技术参数：

- 基 料：水性氟碳树脂。
- 产 品 特 征：水溶性、薄质、透明、亚光/有光。
- 干 燥 时 间：表干2小时，重涂6小时，实干24小时（温度25℃，相对湿度80%）。
- 理论耗漆量：0.12~0.15kg/m<sup>2</sup>，实际涂布量因基面状况、施工方法不同有所差异。

### Technical parameters

- Base material: Waterborne fluorocarbon resin
- Product features: Water solubility, thin, transparent, Matt
- Drying time: dry for 2 hours, Recoat time 6 hours, work for 24 hours. (Temperature 25℃, relative humidity 80%)
- consumption of paint: 0.12~0.15kg/m<sup>2</sup>, the actual coating by surface conditions, construction methods varied.

### 施 工：

- 施工方法：刷涂、滚涂、喷涂。
- 稀释比例：不建议稀释。
- 施工要求：在5℃-35℃及相对湿度80%以下施工。大风、下雨等恶劣天气应避免施工。

### Technical parameters

- Construction method: Brush, roller coating, spray
- Dilution ratio: Not recommended for dilution
- Construction requirements: 5℃ ~35℃ and relative humidity below 80% construction. Construction of wind, rain and other inclement weather should be avoided.

### 配套产品：

Accessory products

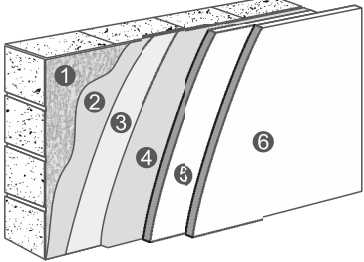

- |           |
|-----------|
| ① 厦光天然真石漆 |
| ② 厦光花岗岩涂料 |
| ③ 厦光岩彩石涂料 |
| ④ 厦光斑彩石涂料 |
| ⑤ 厦光质感涂料  |
| ⑥ 厦光仿砖涂料  |
- |                              |
|------------------------------|
| ① Natural really stone paint |
| ② Granite paint              |
| ③ Rock stone coating         |
| ④ Ammolite coatings          |
| ⑤ Texture paint              |
| ⑥ Faux brick paint           |

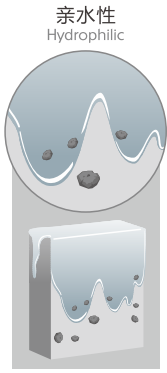

易与水相容的漆膜  
(亲水漆膜)

由于亲水性强 污物容易脱落

Easy compatibility with water varnish  
(hydrophilic coating)

Due to the hydrophilic dirt come off easily



不易与水相容的漆膜  
(憎水漆膜)

由于憎水性强 污物不容易脱落

Not compatible with water varnish  
(hydrophobic coating)

Due to the strong hydrophobicity dirt does not come off easily