

TDS Nature stone coating

厦光TDS天然真石漆



产品简介：

采用高分子防水型硅丙乳液为粘结剂，以天然花岗岩石砂为主要展色系统研制而成。它完全克服了常规真石漆遇雨水冲易泛白、紫外光照射易泛黄、附着力不够牢固、耐污性差等缺点，为传统真石漆升级产品，是一种持久耐用的优质豪华型天然真石漆。

Product features:

Use of polymer waterproof silicone-acrylic emulsion Binder, using natural granite sand to show color system developed by. It completely overcome the conventional stone washed white paint, UV irradiation, prone to yellowing, weak adhesion, resistance to dirt poor, traditional stone paint upgrade products, is a durable high quality luxury natural really stone paint.

性能特点：

- 庄重石材质感
- 长期雨淋不泛白
- 永不褪色
- 优异的抗沾污性
- 不易变黄
- 憎水透气
- 弥盖墙体裂缝
- 附着力强
- 非常适合外保温墙面

Application of places

- Stately stone effects
- Good waterproofing
- Long rains not white
- Excellent weatherability
- Never fade
- Matching the insulation is good
- Adhesive strong
- Superior dirt resistance of



适用场所：

需要展现石材效果的建筑物墙面，尤其适合于高层建筑、住宅小区等中高档建筑以及各种外墙外保温工程等。

Application of places

Need to show effect of stone walls, particularly suitable for high-rise buildings, residential areas and other high-end building and various exterior wall thermal insulation works.

技术参数：

基料：丙烯酸硅共聚乳液。
 颜色：样板、色卡或提供来样。
 产品特征：水溶性、彩色、厚质。
 干燥时间：表干12小时，重涂24小时，实干48小时（温度25℃，相对湿度80%）。
 理论耗漆量：4.5-5.5kg/m²，实际涂布量因基面粗糙程度、施工方法、花型不同而略有差异。

Technical parameters

Base material: Silicon-acrylic copolymer emulsion
 Color: Templates, color cards or provide sample
 Product features: Water soluble, coloured, thick texture
 Drying time: Surface dry for 12 hours, re-coating 24 hours, work 48 hours (temperature 25℃, relative humidity 80%)
 Theory of the consumption of paint: 4.5-5.5kg/m². The actual coating caused by surface roughness, slightly different construction methods, designs vary.

施工：

施工方法：专用喷枪喷涂。
 稀释比例：不宜加水稀释，以免影响装饰效果。确有需要可酌加5%以内清水稀释。
 施工要求：在5℃-35℃及相对湿度80%以下施工。大风、下雨等恶劣天气应避免施工。

Technical parameters

Construction method: special spray.
 Dilution ratio: should not be diluted with water, so as not to affect the decorative effect. Genuine need may be subject to additional 5% less than clear water dilution.
 Construction requirements: 5℃-35℃, relative humidity below 80% construction.
 Construction of wind, rain and other inclement weather should be avoided.

施工工艺

Construction technology

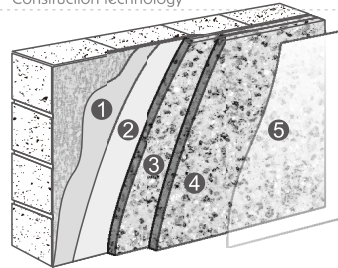

- ① 基层：厦光中层柔性腻子/厦光专用中层腻子2-3遍
- ② 底层：厦光抗碱封闭底漆1遍
- ③ 中层一：厦光TDS天然真石漆1遍
- ④ 中层二：厦光TDS天然真石漆1遍
- ⑤ 面层：厦光罩面涂料1-2遍

- ① The grass-roots level: Dedicated middle managers Middle flexible PuTTY/Terminal light PuTTY 2-3
- ② Bottom: Alkali-resistant primer 1 times
- ③ Middle layer: Natural really stone paint TDS 1 times
- ④ Intermediate II: Natural really stone paint TDS 1 times
- ⑤ Surface: Overlay coating 1-2

典型特点

Typical features

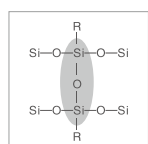

TDS采用硅丙乳液、CDS采用纯丙乳液、足够乳液含量，防水、耐久。

TDS uses silicone-acrylic emulsion, used CDS acrylic latex, latex enough content, water resistant and durable.



合理彩砂“级配渗融”技术，漆膜致密。Reasonable sand preparation technology, the film also.



与矿山合作，大批量采购彩砂，单批产能60吨，有效避免色差。Cooperation with the mining, bulk purchasing sand, single-batch production capacity of 60 tons, to avoid chromatic aberration.

CDS Nature stone coating

厦光CDS天然真石漆



产品简介：

以纯丙烯酸乳液为粘结剂，采用天然花岗岩碎粒为主要展色系统研制而成，外观庄重严肃，充分展现天然石的丰富质感，具有优异的耐候性、防水性、保色性，是一种既豪华又经济的天然真石漆。

Product features:

Based on pure acrylic emulsion Binder, the use of natural granite pieces as the main vehicle system developed by, the appearance of serious, full of the rich texture of natural stone, with excellent weather resistance, water resistance and color retention, is a natural really stone paint both luxury and economy.

性能特点：

- 天然石材质感
- 优异的耐候性
- 弥盖墙体裂缝
- 耐黄变
- 附着力强
- 造价经济
- 永不褪色
- 防水性好
- 与保温匹配性好

Features:

- Natural stone texture
- Excellent weatherability
- Masked wall cracks
- Non-yellowing
- Strong adhesion
- Economic price
- Never fade
- Good waterproofing
- And holding a good matching



适用场所：

各种建筑物内外墙装饰，完全可以装饰出天然石的效果，尤其适合于外墙外保温工程等。

Application of places:

A variety of Interior and exterior wall decoration, completely decorative natural stone effect, particularly suitable for exterior wall thermal insulation works.

技术参数：

基 料：纯丙烯酸聚合物乳液。
 颜 色：样板、色卡或提供来样。
 产 品 特 征：水溶性、彩色、厚质。
 干 燥 时 间：表干12小时，重涂24小时，实干48小时（温度25℃，相对湿度80%）。
 理论耗漆量：4.5-5.5kg/m²，实际涂布量因基面粗糙程度、施工方法、花型不同而略有差异。

Technical parameters:

Base material: Pure acrylic polymer emulsion.
 Color: Templates, color cards or provide sample.
 Product features: Water soluble, coloured, thick texture.
 Drying time: Surface dry for 12 hours, re-coating 24 hours, work 48 hours (temperature 25℃, relative humidity 80%)
 The consumption of paint: 4.5-5.5kg/m². The actual coating caused by surface roughness, slightly different construction methods, designs vary.

施 工：

施工方法：专用喷枪喷涂。
 稀释比例：不宜加水稀释，以免影响装饰效果。确有需要可酌加5%以内清水稀释。
 施工要求：在5℃ - 35℃及相对湿度80%以下施工。大风、下雨等恶劣天气应避免施工。

Technical parameters:

Construction method: special spray.
 Dilution ratio: should not be diluted with water, so as not to affect the decorative effect. Genuine need may be subject to additional 5% less than clear water dilution.
 Construction requirements: 5℃-35℃, relative humidity below 80% construction. Construction of wind, rain and other inclement weather should be avoided.

施工工艺 Construction technology

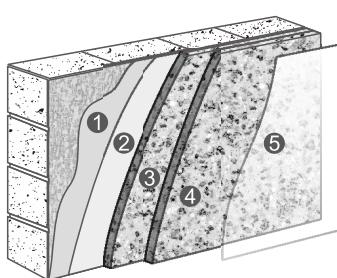

- ① 基 层：厦光中层柔性腻子/厦光专用中层腻子2-3遍
- ② 底 层：厦光抗碱封闭底漆1遍
- ③ 中 层 一：厦光CDS天然真石漆1遍
- ④ 中 层 二：厦光CDS天然真石漆1遍
- ⑤ 面 层：厦光罩面涂料1-2遍

- ① The grass-roots level: Dedicated middle managers Middle flexible PUTTY/Terminal light PUTTY 2-3
- ② Bottom: Alkali-resistant primer 1 times
- ③ Middle layer: Natural really stone paint CDS 1 times
- ④ Intermediate II: Natural really stone paint CDS 1 times
- ⑤ Surface: Overlay coating 1-2

■ 天然彩色石砂性能指标

Natural colored stone sands performance indicators

主要特性 Key Features
色彩稳定 Color stability
耐酸碱 Acid resistance
抗曝晒 Anti-exposure
永不褪色 Never fade
颗粒匀称 Particle symmetry
硬度适中 Moderate hardness