

# Imitation Travertine Series

## 厦光仿洞石系列



### 产品简介：

厦光仿洞石涂料以高分子硅丙聚合物乳液为粘结剂，采用无机天然粉料、精致酸洗石英砂骨料等材料研制而成。该产品通过不同施工工艺，可创造出多种独具匠心的天然洞石效果，给人以自然古朴，粗犷大气的创意之美。

### Product features:

Imitation Travertine silicone-acrylic polymer emulsion paint with high molecular binder, natural inorganic powder, refined pickling quartz sand and other materials developed from aggregate. The product through different construction techniques, can create a variety of distinctive natural travertine effect, gives natural simplicity, rough atmosphere of creative beauty.

### 性能特点：

- 洞石自然纹理
- 超强的耐沾污性
- 优异的耐候性
- 自然古朴，粗犷大气
- 色彩自然，保色性好
- 憎水透气
- 弥盖细裂缝
- 抗酸雨
- 纯天然材料，绿色环保

### Features:

- A simple molding, process
- Thick coatings and crack resistance
- Realistic stone effect
- Shorter, reducing labor costs
- Excellent water resistance
- Excellent resistance to stains
- Layers and stronger
- Strong adhesion
- And holding a good matching

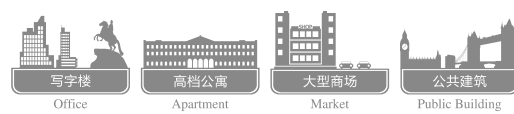

### 适用场所：

需要展现洞石效果的建筑物墙面，尤其适合别墅、排屋、中欧式建筑等高档建筑物。

### Application of places:

Travertine need to show the effect of building the wall, especially for villas, townhouses, and other high buildings in the European architecture.

### 技术参数：

基料：丙烯酸硅共聚乳液。  
 颜色：样板、色卡或提供来样。  
 产品特征：水溶性、彩色、厚质。  
 干燥时间：表干12小时，重涂时间24小时，实干48小时。（温度25℃，相对湿度80%）  
 理论耗漆量：2.50~3.50kg/m<sup>2</sup>，实际视基面粗糙程度、施工方法不同有所差异。

### Technical parameters:

Base material: Silicon-acrylic copolymer emulsion  
 Color: model, color card or provide sample  
 Product Features: Water-soluble, colored, thick quality  
 Drying time: dry for 12 hours, Recoat time 24 hours work for 48 hours. (Temperature 25℃, relative humidity 80%)  
 Consumption of paint: 2.00~3.00kg/m<sup>2</sup>, but the actual surface roughness, construction methods and designs varied.

### 施工：

施工方法：批刮。  
 稀释比例：一般不宜加水稀释，以免影响装饰效果。确因施工需要可酌加5%以内清水稀释。  
 施工要求：在5℃~35℃及相对湿度80%以下施工。大风、下雨等恶劣天气应避免施工。

### Technical parameters:

Construction methods: Scraping  
 Dilution ratio: in general should not be diluted with water, so as not to affect the decorative effect. Indeed due to construction needs can be less than 5% water dilution  
 Construction Requirements: 5℃ ~ 35℃ and relative humidity of 80% or less of construction. Wind, rain and other inclement weather construction should be avoided.

### 典型方案：

Typical scenario:

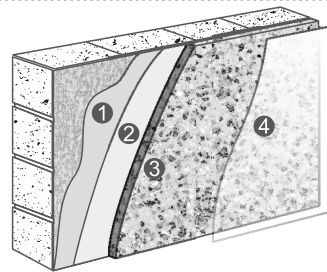

- ① 基层：厦光中层柔性腻子/厦光专用中层腻子2~3道
- ② 底层：厦光含沙专用底漆1道
- ③ 主材：厦光仿洞石涂料2道
- ④ 罩面：厦光罩面涂料1~2道
- ① Grassroots: middle flexible putty / Ha light dedicated middle putty 2 - 3
- ② Bottom: Sand the primer 1
- ③ Main material: Imitation Travertine paint 2
- ④ Overlay: Face paint 1 - 2

