

Natural colored Smooth stone coating

厦光岩彩石CME型·火烧石



产品简介：

厦光岩彩石CME型·火烧石（第三代）突破了固体石砂和液体多彩颗粒高悬浮混合技术壁垒，将水包水涂料和真石漆产品二合一，实现了造型层和多彩颗粒花纹层一枪成型施工工艺，简化了施工工序，缩短施工工期，降低了人工费用，同时，使花纹层次和石材质感更强，达到逼真的石材效果。

Product features:

SUNSHINE rock color stone CME type · fire stone (third generation) breakthrough has solid stone sand and liquid colorful particles high suspended mixed technology barriers, will water package water paint and really stone paint products II unity, achieved has styling layer and colorful particles pattern layer a gun forming construction process, simplified has construction processes, shortened construction duration, reduced has artificial costs, while, makes pattern levels and stone texture more strong, reached realistic of stone effect.

性能特点：

- 一枪成型、工序简单
- 厚质涂层、抗开裂
- 逼真石材效果
- 工期短、降低人工费
- 优异的耐水白性
- 优异抗沾污性
- 层次感和立体感强
- 附着力强
- 与保温匹配性好

Features:

- A simple molding, process
- Crack resistance
- Realistic stone effect
- Shorter, reducing labor costs
- Excellent water resistance
- Excellent resistance to stains
- Layers and stronger
- Strong adhesion
- And holding a good matching

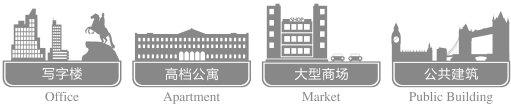

适用场所：

适用于高档商住楼、酒店、写字楼、政府工程、高层建筑等高档建筑物，非常适合外保温墙面上，以代替传统石材。

Application of places:

Suitable for high-end commercial and residential buildings, hotels, office buildings and Government projects, high-rise buildings and other high-end buildings are ideal for insulation on the walls, instead of stone.

技术参数：

基料：氟硅聚合物乳液。
颜色：样板、色卡或提供来样。
产品特征：水溶性、多彩颗粒。
干燥时间：表干12小时，重涂时间24小时，实干48小时。（温度25℃，相对湿度80%）。
理论耗漆量：2.00~3.00kg/m²，实际视基面粗糙程度、施工方法、花型不同有所差异。

Technical parameters:

Base material: fluoro silicone polymer emulsions
Color: model, color cards or provide sample
Product features: water solubility, colorful particles
Drying time: dry for 12 hours, Recoat time 24 hours work for 48 hours. (Temperature 25℃, relative humidity 80%)
Consumption of paint: 2.00~3.00kg/m², but the actual surface roughness, construction methods and designs varied.

施工：

施工方法：专用喷枪喷涂。
稀释比例：不可加水稀释，无需过滤。施工时慢慢搅匀，不可机械搅拌。
施工要求：在5℃~35℃及相对湿度80%以下施工。大风、下雨等恶劣天气应避免施工。

Technical parameters:

Construction method: Special spray
Dilution ratio: Not diluted with water without filtering. Slowly stir in construction, not mechanical agitation.
Construction requirements: 5℃-35℃, relative humidity below 80% construction. Construction of wind, rain and other inclement weather should be avoided.

典型方案：

Typical scenario

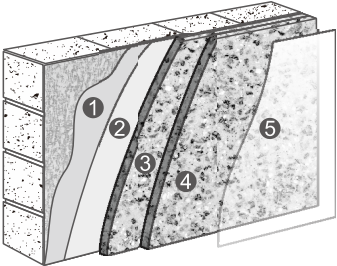

- ① 基层：厦光中层柔性腻子2道
- ② 底层：厦光抗碱封闭底漆1道
- ③ 中涂：厦光岩彩石实色中涂1道
- ④ 主材：厦光CME岩彩石涂料1~2道
- ⑤ 罩面：厦光罩面涂料1~2道
- ① The grass-roots level: mid-level flexible PUTTY 2
- ② Bottom: alkali-resistant primer 1
- ③ Coating: light colored rock stones coated in solid color 1
- ④ Main material: CME Rock light colored stone paint 1~2
- ⑤ Cover: HA mask paint 1~2 road

性能特点

Product Features



- 层次感和立体感强
- 逼真石材效果
- Layers and stronger
- Realistic stone effect



- 优异的耐水白性
- Excellent water resistance



- 无机颜料，不褪色
- Inorganic pigments, color won't fade



- 厚质涂层、抗开裂
- Flexible indemnity cover cracks in the wall



- 优异的耐候性
- Excellent weatherability



- 一枪成型、工序简单
- 工期短、降低人工费
- Shorter, reducing labor costs